



HeySea



ASTERIA 116
built by HeySea



Asteria 116



Introduction to Heysea Yachts

Founded by a group of internationally experienced naval architects and engineers in 2007, Heysea is China's leading manufacturer of custom and production yachts in the mid-to-large range. Combining Chinese manufacturing experience and the western culture of yachting, Heysea is defying the Chinese product stereotypes priding itself in high quality and product flexibility.

Located in China's Pearl River Delta near Hong Kong, Heysea's shipyard allows for the simultaneous construction of more than ten yachts and a maximum length exceeding 164ft. Following the introduction of Heysea's first and immensely popular model Heysea 75 in 2007 the company has now successfully delivered more than 100 composite and steel yachts. As a direct result the company climbed nine places since 2015 and is presently ranked 16th in Boat International Media's "Global Order Book," for 2018 - making it the largest manufacturer of luxury yachts in China.

Introducing at least one new yacht designs every year, Heysea's success is built on a strong in-house team of dedicated engineers, designers and craftsmen. With the ability to provide the full package from concept to delivery, Heysea is known for its competitively priced and highly customizable yachts. Establishing relationships with brokers around the world, Heysea's close cooperation with international design studios and yacht management companies has already landed the company several overseas clients for 100ft+ yachts and building to International Class; barely ten years after its founding.

Conveniently located on the South coast of China's industrial powerhouse province Guangdong and in close proximity to Hong Kong, Heysea has formed close ties with local, national and international suppliers. Besides the advantage for customers to choose from a variety of materials, systems and solutions, it enables the company to perfectly balance cost, quality and compatibility - resulting in outstanding luxury yachts for our customers.



SUN Deck forward part
with Dining, Bar, Day head
and Upper Steering position

SUN Deck aft part
with Jacuzzi and BBQ

MAIN Deck aft part
Alfresco dining
Sun pad

CABANA
with Swimming
platform

PILOTHOUSE

OWNER'S CABIN
or COUNTRY KITCHEN
with 240 degree view

OWNER'S Terrace

VIP Cabin
or Owner's Cabin
or two Guest's Cabins

SALON
with full height sliding
doors on both sides

Profile view

The Asteria 116 is a raised pilothouse design and comes standard with the owner on the main deck, with 5 staterooms. The on deck master stateroom is literally wrapped with glass for maximum visibility and light.

The vessel can also be ordered with a very large Country Kitchen layout forward on the main deck and 4 staterooms below.

Asteria 116





Asteria 116





Asteria 116





Sun deck

The Sun deck comes standard with a beautiful hard top, a central mast design with a day head, a Jacuzzi tub, "alfresco dining," European barbecue, fully equipped exterior helm station and plenty of sunning or shade, according to the buyer's preference.





Asteria 116





Forward terrace

The forward area, Owner's or Country kitchen's terrace, with a solution of "hiding" (swinging sun-pad) the mooring gear and shade of the sun awning, become a beautiful bonus area.





Cabana

The aft swim platform, "Beach Club," comes standard with an air conditioned Cabana, a "glass transom." Another standard swim platform feature is the large OpacMare Transformer for facilitating swimming, diving, gangway, and tender storage/launch.





Salon

The interior of each Asteria 116 is from UNIELLÉ Design. Many choices for woods, leather, upholstery and stone will allow each buyer to customize their decor according to the general arrangement of the cabinetry.

One of the focuses was to get as much as possible light and wide views to enjoy all the beautiful landscapes where the yacht is cruising.



Asteria 116





Lobby

The Lobby with onyx exposed and wide staircase is a central communication and vessel entering area.





Owner's cabin

Owner's stateroom offers about 240 degrees view, entrance to the forward terrace, skylight that can be shaded, double pull-out TV (to be watched from the cabin or from the terrace), step-in wardrobe and fully equipped bathroom with double sink.



Asteria 116





Asteria 116





Galley

The galley is designed as a professional kitchen with all the required hardware and storage, but to also to offer a warm appearance of a home kitchen.





Pilothouse

The Pilothouse is based on the experience of many captains. Standard equipment on a ergonomic positions, good visibility, storage place and raised sofa ensure a comfortable steering.



Layout Variations

Sun Deck

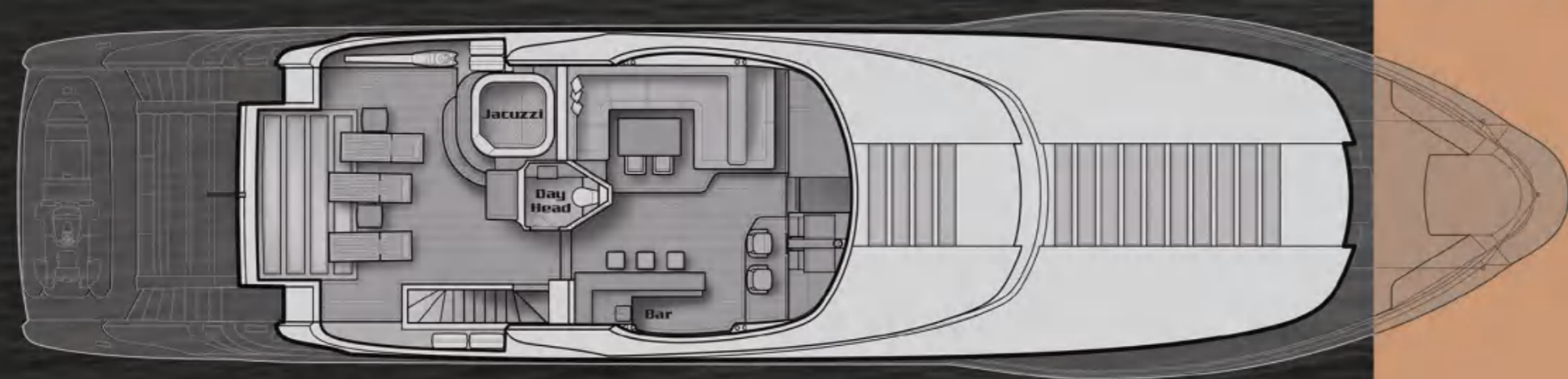

Sun Deck aft area
with 17ft tender, jetski and sun pad variation

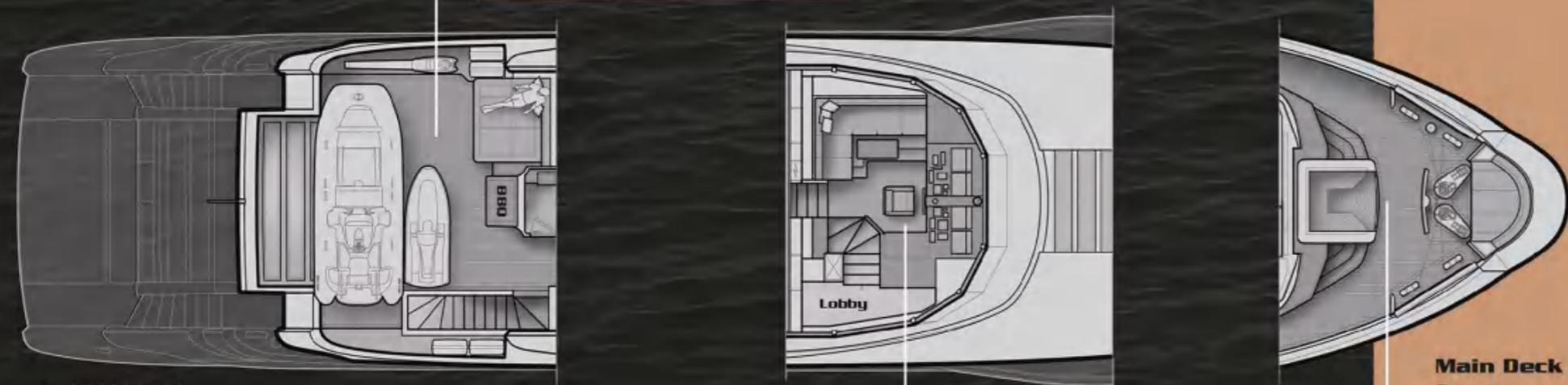

Pilothouse

Main Deck fw area
with mooring operation and Jacuzzi variation

Main Deck Owner's Version

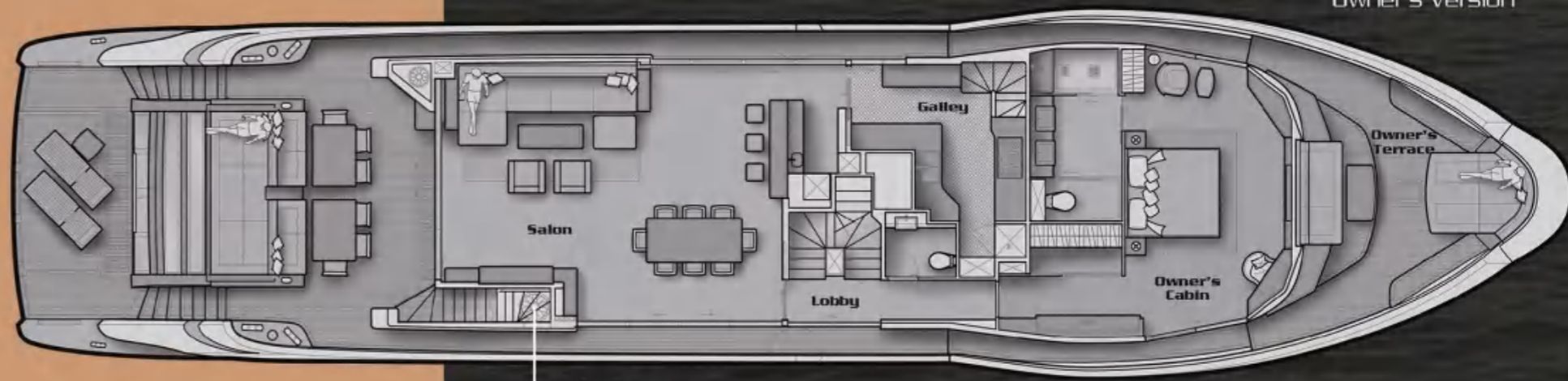

Engine room
Entrance

Multifunctional platform
Transformer

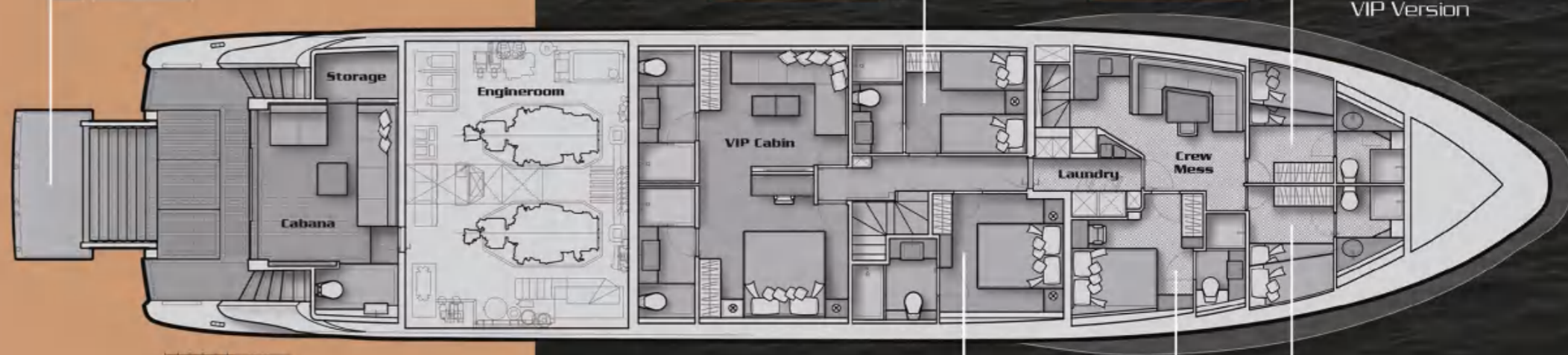

Guest Cabin 01

Crew Cabin 01

Lower Deck VIP Version

Guest Cabin 02

Captain's Cabin

Crew Cabin 02

Layout Variations

Main Deck

Country Kitchen
Version

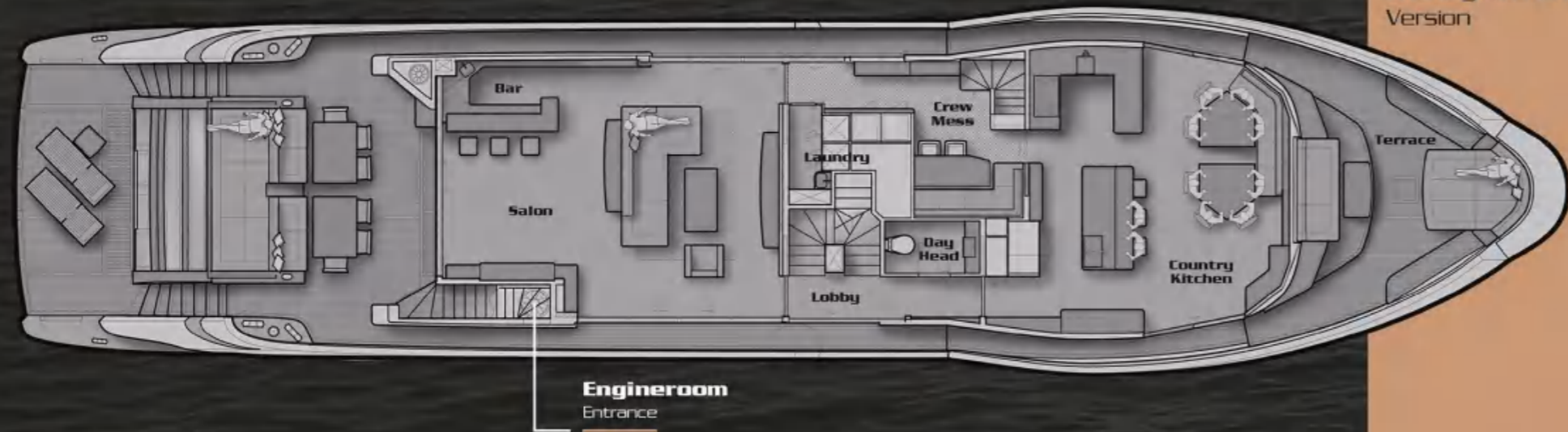

Multifunctional platform Transformer

Owner's Cabin

Guest Cabin 01

Captain's Cabin

Crew Cabin 01

Lower Deck

Owner Version

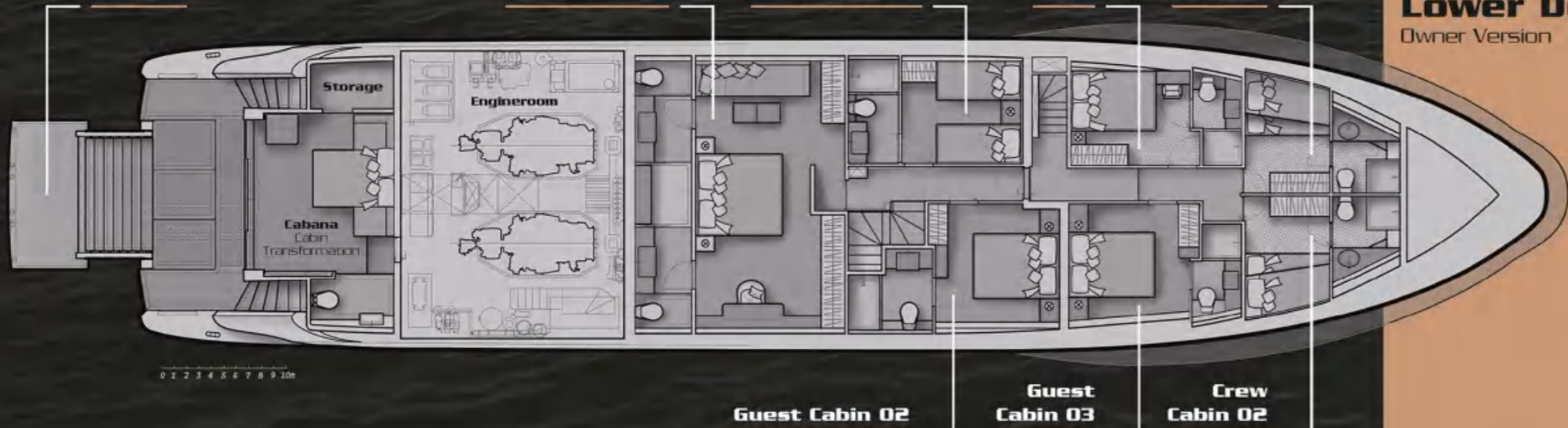

Paint Variations

Carmin Red



LeMans Blue



Grey



Coffee Brown



Specification

Length overall:	35.20m (115'6")
Length waterline:	33.92m (111'4")
Beam:	7.68m (25'2")
Draft:	Full load to BL: 1.60m (5'3") Half load to BL: 1.52m (4'97")
Speed:	Max @ half load: 23kn Cursing @half load: 20kn
Range:	2000nm @ 10kn
Gross tonnage:	263
Guest:	10-12
Crew:	5-6
Tender [owner supplied] :	Max length: 5.5m (18')
Displacement:	Full load: 172.8t Half load: 156.5t
Tank capacity:	Fuel oil: 20,600l (5,441 US gallon) Fresh water: 4,500l (1,188 US gallon) Black water: 2,500l (660 US gallon) Grey water: 2,500l (660 US gallon)
Material for hull and superstructure:	FRP
Main engine [standard configuration]:	2 X CAT C-32 Acert 1900 hp
Propeller:	2 x 5 Blades
Generator:	2 x Kohler 65kW
Bow thruster [stern thruster optional]:	16"-65hp
Shore power converter:	63kVA
Stabilizer:	ABT-TRAC 370/16x (2 fins), zero speed
Z lift:	Oceanstainless-SWL 1000kg
Air conditioning:	Climma
Classification:	RINA/MCA LY3, short range
Flag:	Cayman Islands
Builder:	Heysea Yachts
Exterior and interior design:	UNIElle Yacht Design





Asteria 116